



Village of Mt. Zion

Application for Plan Examination and Building Permit

Approved: _____
Date: _____

Important - Applicant to complete all items in sections: I, II, III, IV, and IX.

I. Location of Building At (location) _____ Zoning District _____
 (no.) (Street)
 Between _____ and _____
 (Cross Street) (Cross Street)
 Subdivision _____ Lot _____ Block _____ Lot Size _____

II. Type and Cost of Building - All applicants complete Parts A - D

<p>A. Type of Improvement</p> <p>1 <input type="checkbox"/> New Building</p> <p>2 <input type="checkbox"/> Addition (If residential, enter number of new housing units added, if any, in Park D, 13)</p> <p>3 <input type="checkbox"/> Alteration (see 2 above)</p> <p>4 <input type="checkbox"/> Repair, replacement</p> <p>5 <input type="checkbox"/> Wrecking (If multifamily residential, enter number of units in building in Park D,13)</p> <p>6 <input type="checkbox"/> Moving (relocation)</p> <p>7 <input type="checkbox"/> Foundation Only</p>	<p>D. Proposed Use - For "Wrecking" most recent use</p> <table border="0"> <tr> <td>Residential</td> <td>Nonresidential</td> </tr> <tr> <td>12 <input type="checkbox"/> One Family</td> <td>18 <input type="checkbox"/> Amusement, recreation</td> </tr> <tr> <td>13 <input type="checkbox"/> Two or More Family - Enter number of units _____</td> <td>19 <input type="checkbox"/> Church, other religious</td> </tr> <tr> <td>14 <input type="checkbox"/> Transient hotel, motel, or dormitory - Enter number of units _____</td> <td>20 <input type="checkbox"/> Industrial</td> </tr> <tr> <td>15 <input type="checkbox"/> Garage</td> <td>21 <input type="checkbox"/> Parking garage</td> </tr> <tr> <td>16 <input type="checkbox"/> Carpet</td> <td>22 <input type="checkbox"/> Service station, repair garage</td> </tr> <tr> <td>17 <input type="checkbox"/> Other - Specify _____</td> <td>23 <input type="checkbox"/> Hospital</td> </tr> <tr> <td></td> <td>24 <input type="checkbox"/> Office, bank, professional</td> </tr> <tr> <td></td> <td>25 <input type="checkbox"/> Public utility</td> </tr> <tr> <td></td> <td>26 <input type="checkbox"/> School, library, other educational</td> </tr> <tr> <td></td> <td>27 <input type="checkbox"/> Stores, mercantile 29 <input type="checkbox"/> Other - Specify _____</td> </tr> <tr> <td></td> <td>28 <input type="checkbox"/> Tanks, towers _____</td> </tr> </table>	Residential	Nonresidential	12 <input type="checkbox"/> One Family	18 <input type="checkbox"/> Amusement, recreation	13 <input type="checkbox"/> Two or More Family - Enter number of units _____	19 <input type="checkbox"/> Church, other religious	14 <input type="checkbox"/> Transient hotel, motel, or dormitory - Enter number of units _____	20 <input type="checkbox"/> Industrial	15 <input type="checkbox"/> Garage	21 <input type="checkbox"/> Parking garage	16 <input type="checkbox"/> Carpet	22 <input type="checkbox"/> Service station, repair garage	17 <input type="checkbox"/> Other - Specify _____	23 <input type="checkbox"/> Hospital		24 <input type="checkbox"/> Office, bank, professional		25 <input type="checkbox"/> Public utility		26 <input type="checkbox"/> School, library, other educational		27 <input type="checkbox"/> Stores, mercantile 29 <input type="checkbox"/> Other - Specify _____		28 <input type="checkbox"/> Tanks, towers _____	
Residential	Nonresidential																									
12 <input type="checkbox"/> One Family	18 <input type="checkbox"/> Amusement, recreation																									
13 <input type="checkbox"/> Two or More Family - Enter number of units _____	19 <input type="checkbox"/> Church, other religious																									
14 <input type="checkbox"/> Transient hotel, motel, or dormitory - Enter number of units _____	20 <input type="checkbox"/> Industrial																									
15 <input type="checkbox"/> Garage	21 <input type="checkbox"/> Parking garage																									
16 <input type="checkbox"/> Carpet	22 <input type="checkbox"/> Service station, repair garage																									
17 <input type="checkbox"/> Other - Specify _____	23 <input type="checkbox"/> Hospital																									
	24 <input type="checkbox"/> Office, bank, professional																									
	25 <input type="checkbox"/> Public utility																									
	26 <input type="checkbox"/> School, library, other educational																									
	27 <input type="checkbox"/> Stores, mercantile 29 <input type="checkbox"/> Other - Specify _____																									
	28 <input type="checkbox"/> Tanks, towers _____																									
<p>B. Ownership</p> <p>8 <input type="checkbox"/> Private (individual, corporation, nonprofit institution, etc.)</p> <p>9 <input type="checkbox"/> Public (Federal, State, or Local Government)</p>																										

<p>C. Cost</p> <p>10. Cost of improvement..... \$ _____</p> <p>To be installed but not included in the above cost</p> <p>a. Electrical.....</p> <p>b. Plumbing.....</p> <p>c. Heating, air conditioning.....</p> <p>d. Other (elevator, etc.).....</p> <p>11. Total Cost of Improvement \$ _____</p>	<p>(Omit Cents)</p>	<p>Nonresidential - Describe in detail proposed use of buildings, e.g. , food processing plant, machine shop, laundry building at hospital, elementary school, secondary school, college, parochial school, parking garage for department store, rental office building, office building at industrial plant. If use of existing building is being changed, enter proposed use.</p>
---	---------------------	---

III. Selected Characteristics of Building - For new building and additions, complete Parts E-L;

<p>E. Principal Type of Frame</p> <p>30 <input type="checkbox"/> Masonry (wall Bearing)</p> <p>31 <input type="checkbox"/> Wood Frame</p> <p>32 <input type="checkbox"/> Structural Steel</p> <p>33 <input type="checkbox"/> Reinforced concrete</p> <p>34 <input type="checkbox"/> Other - Specify _____</p>	<p>for wrecking, complete only Part J, for all others skip to IV.</p>	
<p>F. Principal Type of Heating Fuel</p> <p>35 <input type="checkbox"/> Gas</p> <p>36 <input type="checkbox"/> Oil</p> <p>37 <input type="checkbox"/> Electricity</p> <p>38 <input type="checkbox"/> Coal</p> <p>39 <input type="checkbox"/> Other - Specify _____</p>	<p>G. Type of Sewage Disposal</p> <p>40 <input type="checkbox"/> Public or private company</p> <p>41 <input type="checkbox"/> Private (septic tank, etc.)</p>	<p>J. Dimensions</p> <p>48. Number of Stories.....</p> <p>49. Total square ft. of floor area, all floors, based on exterior dimensions.....</p> <p>50. Total land area, sq. ft K. Number of off Street Parking Places</p> <p>51. Enclosed</p> <p>52. Outdoors</p>
	<p>H. Type of Water Supply</p> <p>42 <input type="checkbox"/> Public or private company</p> <p>43 <input type="checkbox"/> Private (well, cistern)</p>	<p>I. Type of Mechanical</p> <p>Will there be central air conditioning?</p> <p>44 <input type="checkbox"/> Yes 45 <input type="checkbox"/> No</p> <p>Will there be an elevator?</p> <p>46 <input type="checkbox"/> Yes 47 <input type="checkbox"/> No</p>

IV. Identification - to be completed by all applicants					
Name	Mailing address - Number, Street, City, and State			Zip Code	Tel. No.
1. Owner or Lessee				Builder's License No.	
2. Contractor					
3. Architect or Engineer					
I hereby certify that the proposed work is authorized by the owner of record and that I have been authorized by the owner to make this application as his authorized agent and we agree to conform to all applicable laws of this jurisdiction.					
Signature of applicant		Address		Application date	

DO NOT WRITE BELOW THIS LINE

V. Plan Review Record - For office use							
Plans Review Required	Check	Plan Review Fee	Date Plans Started	By	Date Plans Approved	By	Notes
Building		\$					
Plumbing		\$					
Mechanical		\$					
Electric		\$					
Other _____		\$					

VI. Additional Permits Required or Other Jurisdiction Approvals									
Permit or Approval	Check	Date Obtained	Number	By	Permit or Approval	Check	Date Obtained	Number	By
Boiler					Plumbing				
Curb or Sidewalk Cut					Roofing				
Elevator					Sewer				
Electrical					Sign or Billboard				
Furnace					Street Grades				
Grading					Use of Public Areas				
Oil Burner					Wrecking				
Other _____					Other _____				

VII. Validation		FOR DEPARTMENT USE ONLY	
Building		Use Group	_____
Permit Number _____		Fire Grading	_____
Building		Live Loading	_____
Permit issued _____ 20_____		Occupancy Load	_____
Building			
Permit Fee \$ _____			
Certificate of Occupancy	\$ _____		
Drain Title	\$ _____		
Plan Review Fee	\$ _____	Approved by:	_____

Site or Plot Plan Instructions

Show on the map 1. All existing structures, 2. The proposed structure with dimensions in feet, 3. The distance in feet from the property line to the proposed foundation, 4. The direction of North, 6. And if detached, the distance from the primary structure to the proposed accessory structure. (10 foot minimum).

IX. Site or Plot Plan - For Applicant Use

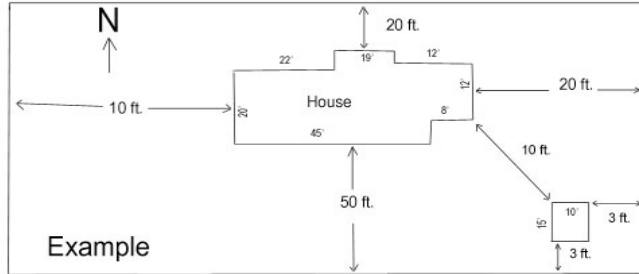

A large grid area provided for the applicant to draw their site plan. The grid is approximately 30 units wide and 40 units high.

**Village of Mt. Zion
Building Permit Application
Part 2**

Contractor	Contact Name	Address	City, State, Zip Code	Phone #	License #
-------------------	---------------------	----------------	------------------------------	----------------	------------------

Plumbing:

Electrical:

Mechanical:

Concrete/Sidewalk/Driveway Approach:

Contractor License #
